

100 drive in

Drive-in accumulated storage
to optimise available space

ISO 9001



Racking all over the world

POLYPAL
Polypal House
Monckton Road Industrial Estate
Wakefield, West Yorkshire, WF2 7AL
Tel: 01924 200015
Fax: 01924 201160

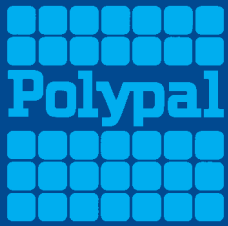

**DRIVE-IN:
Accumulated Storage
Racking with the
following advantages:**

Cost Effectiveness

High rise and in-depth storage applications.

60% to 80% increase in storage capacity.

Operating aisles minimised.

**A Multi-Application
Product**

Storage of large quantities of different products.

Ability to cope with load overhang.

Multi-Sectors

Suited for both ambient and cold store applications.



**Cost effectiveness
is assured.**



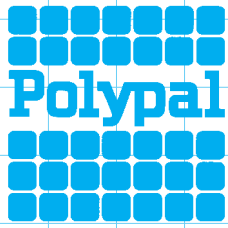

General Design

Use of Maxipal and Stockpal uprights and all accessories.

Wear resistant galvanised drive-in support rail.

Rail fixing with two bolts on each upright, ensuring the stability of the whole installation.

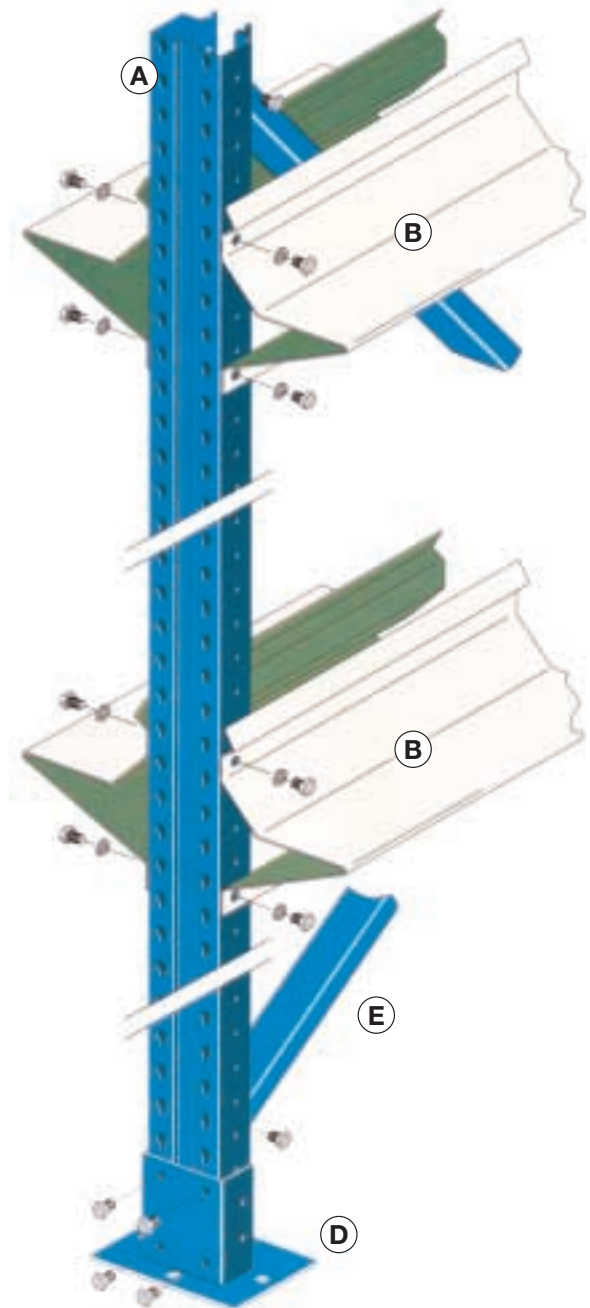
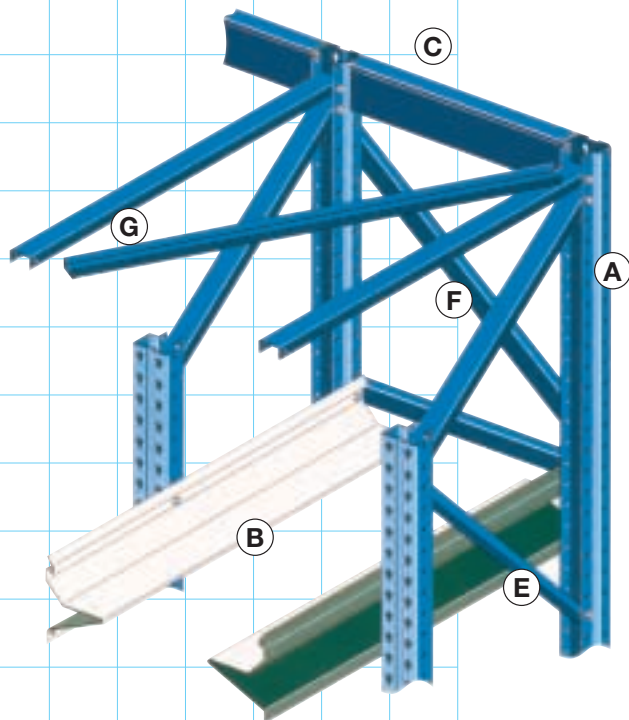

- A. Maxipal or Stockpal upright.
- B. Support rail.
- C. Beam.
- D. Heavy duty base plate.
- E. Frame bracing.
- F. Back bracing.
- G. Top bracing.



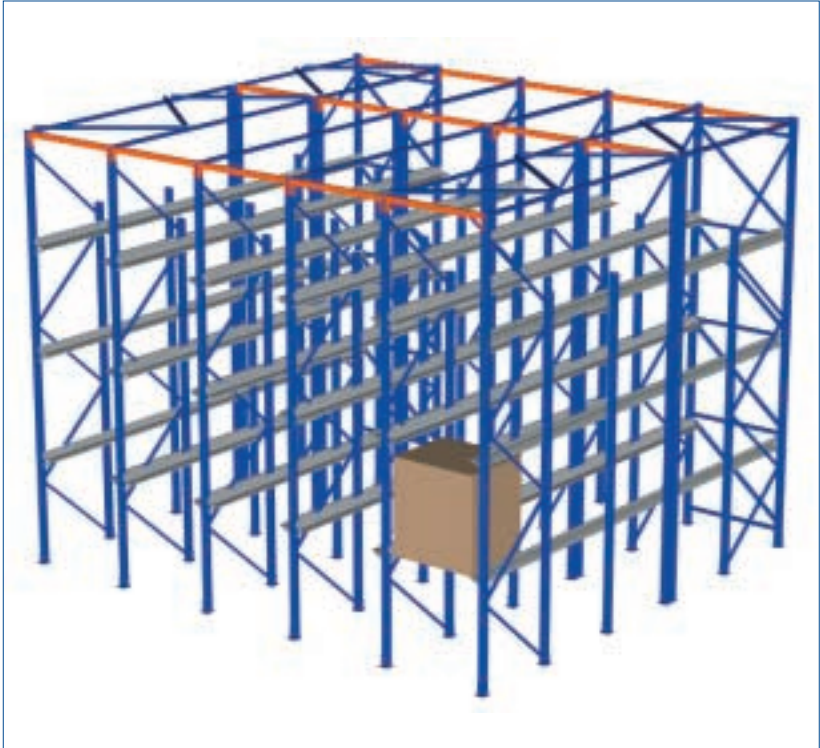

**DRIVE-IN OR
DRIVE-THROUGH
OPTIONS**

Drive-In:

Accumulated storage with single-end lane access.

Drive-Through:

Accumulated storage with double-end lane access giving improved stock rotation.

Drive-in is a perfect complement to other products in the Polypal range.

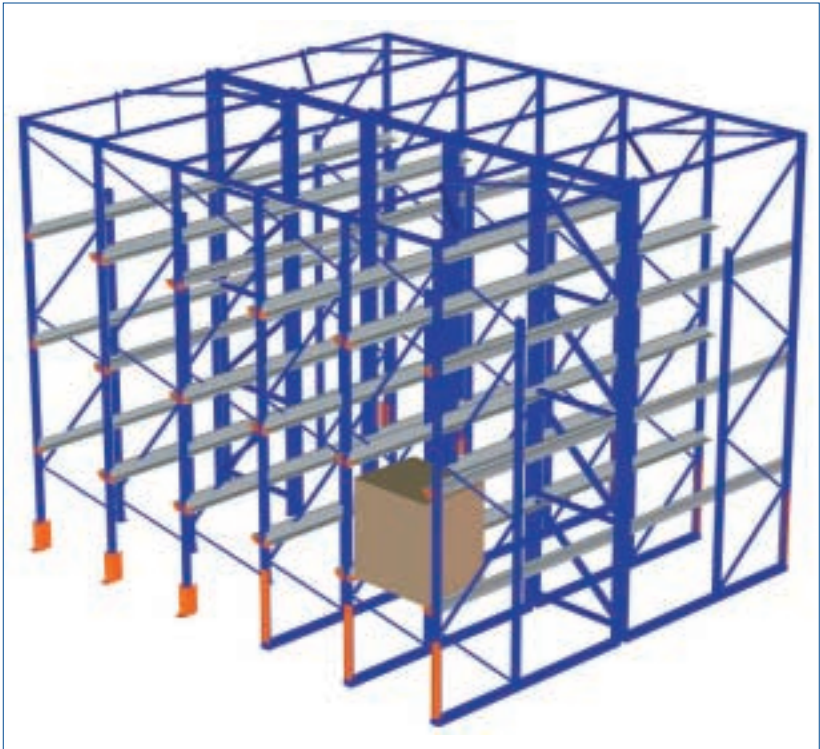

Optional rail entry guide



100 drive in

Drive-in accumulated storage
to optimise available space

ISO 9001



FINISH

All Drive-in components have a first class finish of electrostatically applied epoxy powder coating baked on at 200°C to a thickness of 40 microns.

The standard colours are:



BLUE RAL 5001



ORANGE RAL 2004

THE DRIVE-IN RAIL
IS MANUFACTURED
FROM SENDZIMIR
GALVANISED STEEL

Distributed by

